

VSG

REMINGTON VALVE

Severe Service Ball Valves



**VALVE
SELECTION
GUIDE**

Custom designs – Innovative technology

**CRITICAL SERVICE
FIELD PROVEN
ENGINEERED
SUPPORT
SERVICE**

Manufactured in Houston, Texas

WHY CHOOSE REMINGTON VALVE?

REMINGTON VALVE located in Houston, Texas is a leading manufacturer of Severe Service Ball Valves (SSBV) for the most critical applications in the Refining, Chemical, Petrochemical, Power Generation, Oil & Gas, Mining, Aerospace industries. Decades of Severe Service Ball Valve (SSBV) experience is utilized in the innovative engineering, manufacturing, cutting edge technology and field proven designs to help customers like you.

Why Choose **REMINGTON VALVE**:

- Optimized ball valve design and calculations
- 3D Parametric modeling
- Cutting edge coating technologies
- Automated lapping processes
- Vacuum testing to validate Class VI shut-off
- All valves built to ASME B16.34
- Field Proven designs for isolation challenges

Engineered Solutions for:

- Refining
- Chemical / Petrochemical
- Power Generation
- Upstream Oil & Gas
- Mining & Minerals
- Pulp & Paper
- Cryogenic

Applications:

- High Temperature
- Low Temperature
- High Pressure
- Abrasive
- Corrosive
- Erosive
- Lethal

Features and Benefits

Manufactured in Houston, Texas

- **Body:** All valves built from forgings – *not castings*
- **Ball & Seats:** Materials of construction matched for consistent thermal expansion rates
- **Lapping:** Automated lapping process laps both sides of the ball to Class VI
- **Coating:** HVOF and Spray & Fused with cutting edge technology per application
- **Stem:** Surface hardened to eliminate galling
- **Articulating Gland Flange:** Prevents stem binding and galling
- **Spring:** Allows for thermal expansion and provides a constant mechanical force
- **Grafoil Packing:** Premium die-formed with Anti-extrusion rings – Live loaded
- **Open/Closed Indicator:** Scribe line on stem and articulating gland flange
- **Vacuum Testing:** Every ball & seat set is tested to ensure Class VI shut-off prior to installation
- **ASME B16.34:** All valves built to ASME B16.34 requirements



Field proven designs..

Valve Selection Guide

J-SERIES

Applications: Critical Isolation, Lethal Services, Heavy Slurry, Ultra-High Pressure, Catalyst, HPAL, and more.

SIZE

- ½ – 36" (2 or 3 piece)

PRESSURE CLASS

- 150# - 4500#

END CONNECTIONS

- RF, RTJ, HUB, BW, SW

Per Customer Specifications

SEALING OPTIONS

- Uni-directional (Standard)
- Bi-directional (Optional)

MATERIALS

- *Per Customer Specifications*



Flanged Seat Design

R-SERIES

Applications: In-Line Repairable Valve for Power, Chemical and Petrochemical Applications.

SIZE

- ½" – 24"

PRESSURE CLASS

- 150# - 4500#

END CONNECTIONS

- SW Standard (BW, HUB)

Per Customer Specifications

SEALING OPTIONS

- Uni-directional (Standard)
- Bi-directional

MATERIALS

- *Per Customer Specifications*



Patent Pending

www.remingtonvalve.com

VALVE SELECTION GUIDE

Custom designs – Innovative technology

S-SERIES

Applications: Vents and Drains - Economizer, Boiler, Turbine, Feedwater, Sootblower, and more.

SIZE

- ½" – 2 ½"

PRESSURE CLASS

- 150# - 4500# (Limited Class)

END CONNECTIONS

- SW Standard (BW, RF, HUB)

Per Customer Specifications

SEALING OPTIONS

- Uni-directional (Standard)

MATERIALS

- A105, F11, F22, F91, F92



C-SERIES

Applications: Constant Contact Seat and Double Block and Bleed.

SIZE

- ½" – 36"

PRESSURE CLASS

- 150# - 4500#

END CONNECTIONS

- RF, RTJ, HUB, BW, SW

Per Customer Specifications

SEALING OPTIONS

- Bi-directional (Standard)

MATERIALS

- *Per Customer Specifications*

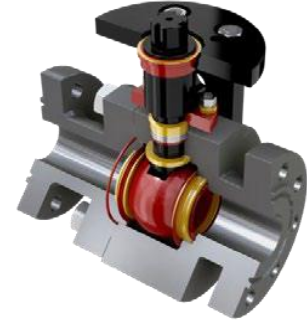

M-SERIES

Applications: Metals & Minerals , Slurry Transport, Autoclave (HPAL), and Pressure Oxidation.

SIZE

- ½" – 36" (2 or 3 piece)

PRESSURE CLASS

- 150# - 4500#

END CONNECTIONS

- RF, RTJ, HUB, BW, SW

Per Customer Specifications

SEALING OPTIONS

- Uni-directional (Standard)

MATERIALS

- *Per Customer Specifications*



E-SERIES

Applications: Overpressure Protection for Boilers and Isolation for Relief Valves .

SIZE

- ½" – 4"

PRESSURE CLASS

- 1500# - 4500#

END CONNECTIONS

- RF, RTJ, HUB, BW, SW

Per Customer Specifications

SEALING OPTIONS

- Uni-directional (Standard)

MATERIALS

- *Per Customer Specifications*

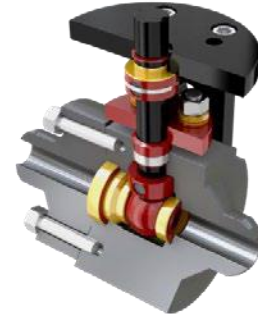

T-SERIES

Applications: Trunnion designs.

SIZE

- ½" – 36" (2 or 3 piece)

PRESSURE CLASS

- 150# - 4500#

END CONNECTIONS

- *Per Customer Specifications*

SEALING OPTIONS

- Bi-directional (Standard)

- Class VI Shut-Off

MATERIALS

- *Per Customer Specifications*



P-SERIES

Applications: Same configuration with application specific seat materials.

SIZE

- ½" – 36" (2 or 3 piece)

PRESSURE CLASS

- 150# - 4500

END CONNECTIONS

- RF, RTJ, HUB, BW, SW

Per Customer Specifications

SEALING OPTIONS

- Uni-directional (Standard)

MATERIALS

- *Per Customer Specifications*



Engineered Solutions for Critical Severe Service Applications.

www.remingtonvalve.com

Custom designs for the toughest applications



Engineered Solutions for Critical Severe Service Applications

REMINGTON VALVE

706 Nebraska Street
South Houston, Texas 77587
O: 832.413.4400 F: 281.974.3595

www.remingtonvalve.com
sales@remingtonvalve.com
service@remingtonvalve.com