

PACKING

REMINGTON VALVE

Severe Service Ball Valves



**PACKING
REPLACEMENT**

Power valves built for performance!

**CRITICAL SERVICE
FIELD PROVEN
ENGINEERED
SUPPORT
SERVICE**

Engineered Solutions for Severe Service Applications



Made in the U.S.A.

REMINGTON VALVE, LLC PACKING REPLACEMENT

WARNING

Avoid personal injury from sudden release of process pressure. Before performing any maintenance operations:

- Do not remove the actuator from the valve while the valve is still pressurized.
- Disconnect any operating lines providing air pressure, electric power, or a control signal to the actuator. Be sure the actuator cannot suddenly open or close the valve.
- Use bypass valves or completely shut off the process to isolate the valve from process pressure. Relieve process pressure from both sides of the valve. Drain the process media from both sides of the valve.
- Vent the power actuator loading pressure and relieve any actuator spring precompression.
- Use lock-out procedures to be sure that the above measures stay in effect while you work on the equipment.
- Always wear protective gloves, clothing, and eyewear when performing any maintenance operations.
- The valve packing area may contain process fluids that are pressurized, even when the valve has been removed from the pipeline. Process fluids may spray out under pressure when removing the packing hardware or packing rings.
- Check with your process or safety engineer for any additional measures that must be taken to protect against process media.
- See "Packing Replacement Section"

CAUTION

Never attempt to work on valve while in service. Use proper lock out procedures and read entire instruction manual before attempting work on the valve.

Packing Replacement

1. Remove valve from service, do not remove packing while valve is in service.
2. Remove handle adapter/actuator bracket and coupling.
3. Remove Snap Ring (28).
4. Remove Bushing (17).
5. Remove Mounting Flange (26, 15, 12).
6. Remove Upper Bushing (14).
7. Remove Upper Pin (9) if present.
8. Remove Upper Collar (13) if present.
9. Remove Nuts (22).
10. Remove Belleville Springs (23) note orientation of springs.
11. Remove Gland Flange (11).
12. Remove Packing Follower (19). The follower is very tight tolerance and may need to be removed by a puller.
13. Remove old packing. Note packing bushing will be on bottom of stuffing box and does not require removal.
14. Replace two pieces of Inner Packing staggering joints by 60 Deg. packing part numbers 1400R. Use packing follower to seat packing rings. Ensure packing joint does not have a gap.
15. Replace one-piece Outer Packing ring. Part number 1601.
16. Compress packing rings using packing follower and gland flange. Place packing follower on stem and slide down to packing, place gland flange on stem and tap on packing follower to compress rings.
17. Replace Belleville springs in orientation removed. Live loading is required. (1 cone up, one down, one up).
18. Tighten nuts according to torque chart found on BOM.
19. Replace all other items in reverse order using torque requirements on BOM.
20. Cycle valve to ensure proper function.
21. Tighten packing live loading nuts to required torque after first elevated pressure and temperature.

Construction Features

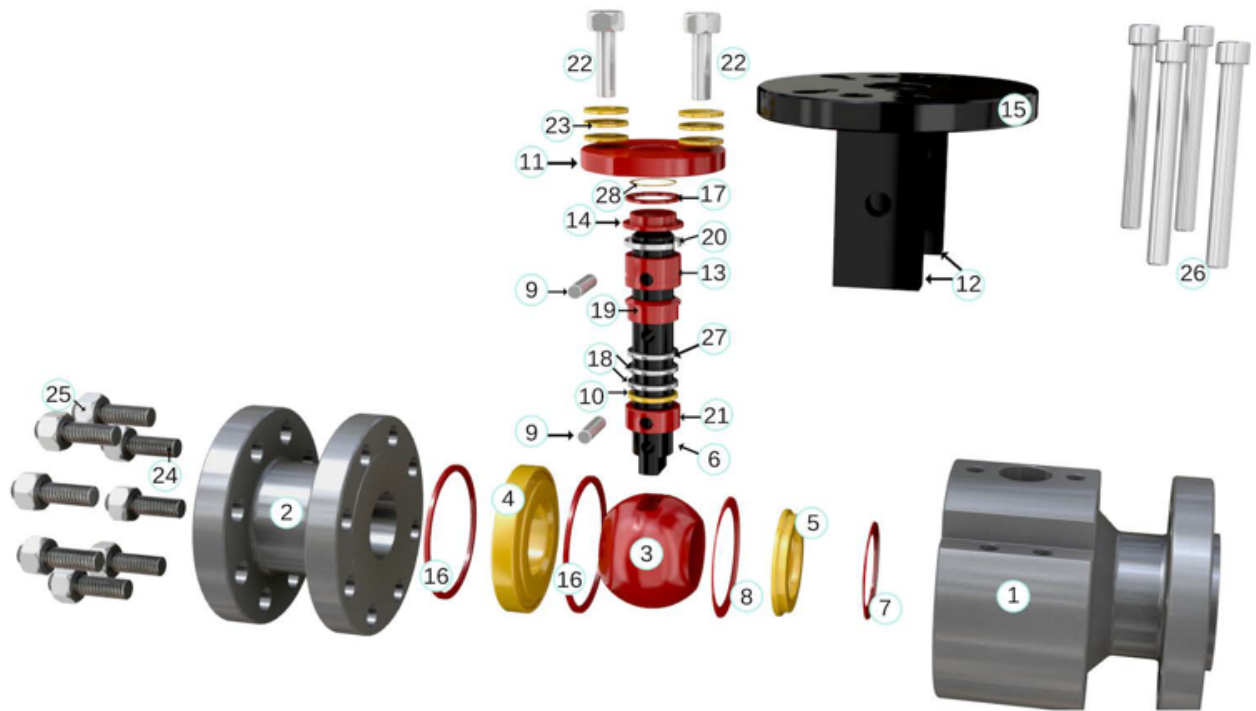

A CLOSER LOOK

- | | |
|---------------------------|---------------------------|
| 1. BODY | 15. MOUNTING FLANGE |
| 2. END CONNECTION | 16. GASKETS BODY |
| 3. BALL | 17. SNAP RING |
| 4. DOWNSTREAM SEAT | 18. PACKING RINGS |
| 5. PUSH RING | 19. PACKING FOLLOWER |
| 6. STEM | 20. HOOPSTER RING |
| 7. INNER LOAD SPRING | 21. INNER COLLAR |
| 8. SOLIDS EXCLUDER SPRING | 22. STUD (GLAND) |
| 9. RETAINER PINS | 23. BELLEVILLE SPRINGS |
| 10. PACKING BUSHING | 24. STUD (BODY) |
| 11. GLAND FLANGE | 25. NUT- HEAVY HEX (BODY) |
| 12. MOUNTING LEG | 26. SOCKET CAP SCREW |
| 13. OUTER COLLAR | 27. ANTI EXTRUSION RING |
| 14. UPPER BUSHING | 28. WASHER |

REMINGTON VALVE

Manufactured in Houston, Texas
 8226 Kerr Street
 Houston, TX 77029

CONTACT US:

www.RemingtonValve.com
sales@RemingtonValve.com

O: 832.413.4400 F: 281.974.3595

WWW.REMINGTONVALVE.COM